



# Compact Video Housing instruction manual

## #5620.02 Sanyo VPC-PD2

### Housing Size and Weight:

- 4" wide x 6" high x 3.6" deep including controls and lens port.
- 10cm x 15cm x 9cm.
- 1lb (450g) above water.
- Slightly positive buoyancy underwater.

### Initial Camera Setup:

1. Insert a fully charged battery.
2. Set Date and Time.
3. Set Flash to "Forced Flash" - lightning bolt.
4. Set Photo resolution to "12M".
5. Set Video Resolution to "Full-SHQ".

### Opening the Housing

1. Place the housing face down in your lap or on a flat surface.
2. Depress opposing latch buttons simultaneously to open housing - **Diagram A**. Once the latch is unlocked, rotate the latch handle up and away from the housing until it stops. This motion will also break the housing o-ring seal and open the housing back slightly - **Diagram B**.

**NOTE:** Latch must be rotated to the fully open position to assure easy opening of the back. Rotate the hinged back to its open position.

### Included in Box:

1. Instruction Manual
2. Compact Video Housing #5620.02
3. Housing Lanyard #0321.10
4. Extra Control Tips
5. Ikelite Lube #0184.1
6. Diffuser
7. Deflector
8. Warranty Card

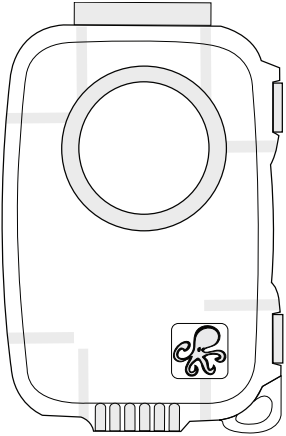

**Congratulations** on your purchase of an Ikelite Compact Video Housing. Ikelite has decades of experience in the underwater photographic, video, and lighting market.

Our products are designed and built in the USA by Ikelite for both the professional and amateur.

The clear housing permits instant visual inspection of the video camera and all sealing surfaces as well as complete monitoring of controls and camera LCD screens.

This housing has been water pressure tested to 200' (60m) at the factory. All camera controls are fully functional through the housing. We suggest that you read this instruction booklet thoroughly to have a full understanding of where each camera control is located, and what function each control provides. If you are new to underwater video and photography, be sure to read the Photo and General Tips sections.

**Diagram A**

Top View - Latch Closed

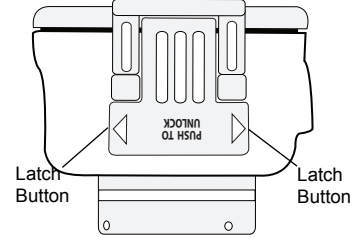

**Diagram B**

Top View - Latch Opened

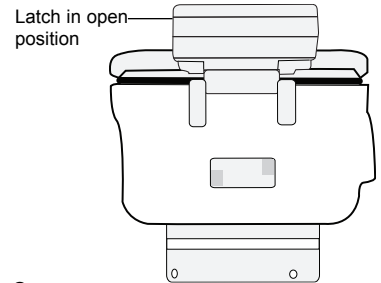

2

### Main Housing O-ring

Check to see that there is an o-ring on the housing back and that it is clean, lightly lubed, and in its proper location - **Diagram C**.

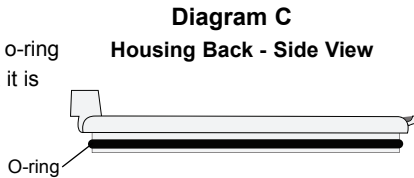

**Diagram C**

Housing Back - Side View

### O-ring Maintenance

We recommend that you clean the main housing o-ring and o-ring channel before each day of diving.

1. To remove the o-ring, place index finger and thumb on the o-ring as shown - **Diagram D**.
2. Squeeze the o-ring into a loop by pressing down on the o-ring and squeezing your index finger and thumb together - **Diagram E**.
3. Grab the o-ring loop with your other hand and remove the o-ring from the housing back.
4. Wipe the o-ring channel clean with a paper towel, napkin, or lint-free wiping cloth.
5. Clean and lightly lube the o-ring. Use Ikelite lube only (supplied with housing).
6. Very lightly lube the o-ring sealing surface on the housing front.

**CAUTION:** Never use a screwdriver or metal object to remove the main housing o-ring. This could damage the housing and o-ring, which could result in a leak.

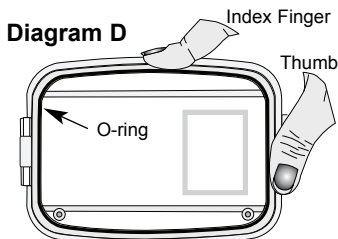

**Diagram D**

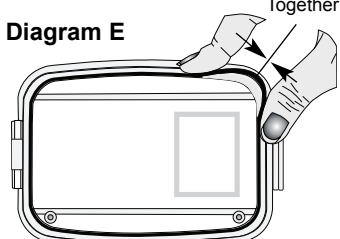

**Diagram E**

3

### Installing the Camera

Place the camera face down into the front housing ribs as shown - **Diagram F**.

### Closing the Housing

Rotate the hinged back onto the housing front. Close the latch and make sure it locks. Latch will "click" into its locked position. Latch buttons will NOT be depressed when latch is properly locked - **Diagram A, Page 2**.

**Diagram F**



### Check Main O-ring Seal and Controls

Rotate the housing 360 degrees from the "Side View" angle - **Diagram C, Page 3**, and note the o-ring seal by looking through the clear housing. A good seal should appear as a solid black line.

Make sure the housing controls line up with the camera controls.

### Turn Camera On

Turn the camera on and operate each of the housing controls to get a feel for using the camera in the housing. Operate the camera above water with the camera in the housing.

**You are now ready to shoot underwater video and photos!**

### Lens Port

Treat the glass in the lens port as a camera lens. After use, rinse and gently dry the outside lens port to avoid water spotting. To clean, use a mild soap solution or lens cleaner. Do not rinse the inside port glass. **Do not use alcohol or window cleaner on the Lens Port.**

4

## Housing Controls

1. Photo Shooting Button
2. Up Arrow
3. Video Recording Button
4. Left Arrow
5. SET Button
6. Right Arrow
7. REC/PLAY Button
8. Down Arrow
9. Flash Button
10. ON/OFF Button

## Optional Accessories

### Main Housing O-ring #0132.45

O-rings last for several years if properly maintained. Always carry a spare in case your housing o-ring becomes damaged or lost.

### Ikelite Lube #5020 (4 - 1cc tubes)

For light lubrication of the main housing o-ring.



Ikelite Lube - 1cc Tube

5

## Optional Accessories (continued)

### Ikelite W-20 Wide-Angle Conversion Lens #6420

For increased angle of coverage, color, and clarity, add the Ikelite W-20 #6420, or other 67mm wide-angle conversion lenses. Ikelite 67mm Threaded Port Adapter #9306.78 is required to attach 67mm conversion lenses to the housing port.

### #9306.78 67mm Threaded Port Adapter

Allows attaching Ikelite W-20 Wide-Angle Conversion Lens #6420 with 67mm threads. Also allows attachment of Epoque, Type II Inon screw-on lenses, and macro lenses or diopters with 67mm threads. Includes larger size removable flash deflector.

### #9306.85 Bayonet Port Adapter

Allows attaching Inon UWL-105 AD, UWL-100 28AD, and UFL-165AD bayonet mount lenses.

**NOTE:** Slight edge softness around the picture edges is normal in some situations. No vignetting was noted with the camera in it's widest angle setting when used with the listed conversion lenses. If vignetting occurs with lenses that are not listed, zoom in to eliminate.

7



Diagram F

## Optional Accessories (continued)

### Lanyard #0321.10 (included with housing)

Included Lanyard can be attached to the molded housing loop when not using an optional tray attachment - **Diagram F, Page 5.**

### UR/Pro Blue Water Filter #6441.31

(included with housing - **Diagram G**)

(Use #6441.42 for W-20 Accessory Lens)

The UR/Pro color correcting filter is designed to restore some of the warm colors filtered out in tropical blue water settings. For use with available light and video lite.

### UR/Pro Green Water Filter #6441.71

(Use #6441.82 for W-20 Accessory Lens)

Enhances contrast and alters the color of green water to give your subject a rich, natural tone. For use with available light and video lite.

**NOTE:** Make sure no air bubbles are trapped between the UR-Pro Filter and housing port. If so, remove the filter underwater, wipe away the bubbles, and re-install filter on the housing port.

Diagram G

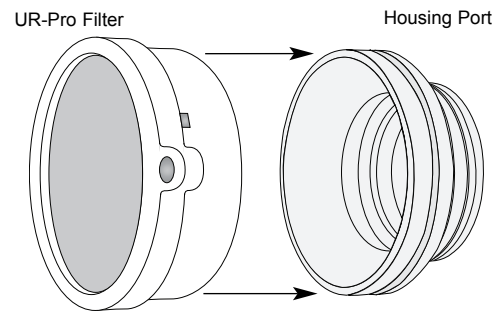

6

## Optional Accessories (continued)

### Video Compact Tray #9523.51

### Dual Tray #9523.52

### Handle #9530.1

Attaches to the Ikelite Compact Video Housing. Allows the attachment of optional Pro-V8 LED Video Lites, PRO-2800 Lites, the Pro Video Lite 3(s), or AF35 Strobe(s). Hardware included with each accessory for easy attachment to your housing. Lites can be attached to a single or dual tray, with or without Handle(s), with the exception of the PRO-2800 Lite. The PRO-2800 Battery Pack requires a Dual Tray for proper attachment.

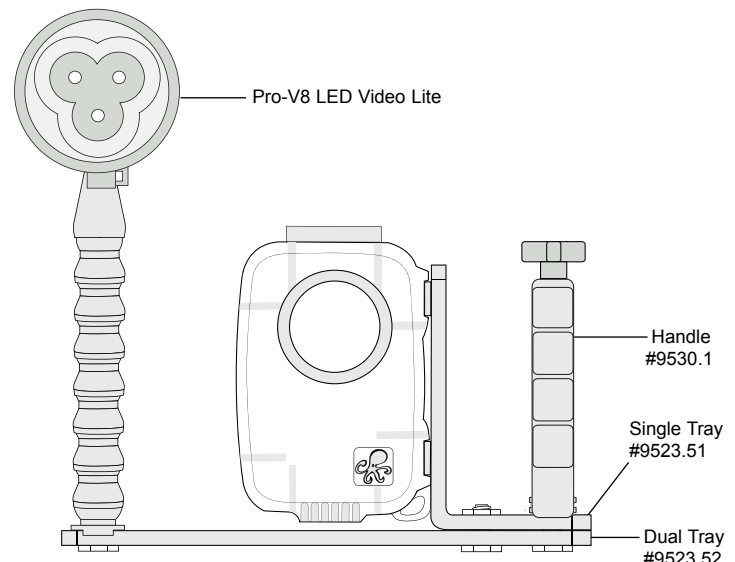

8

## Optional Accessories (continued)

### AF35 Strobe

Add an AF35 AutoFlash Strobe for perfect photos when using the camera's still mode. The AF35 is optically triggered by the camera's flash and provides TTL Automatic exposure without any exposed cables to maintain or replace. Requires the #9523.51 Video Compact Tray and #9523.53 Adapter Mount Kit, sold separately. Dual Tray #9523.52 can be added to attach both an AF35 AutoFlash Strobe and Pro-V8 Video Lite.

### #4035 AF35 AutoFlash Primary Flash Kit

### #4035.1 AF35 AutoFlash Secondary Flash Kit

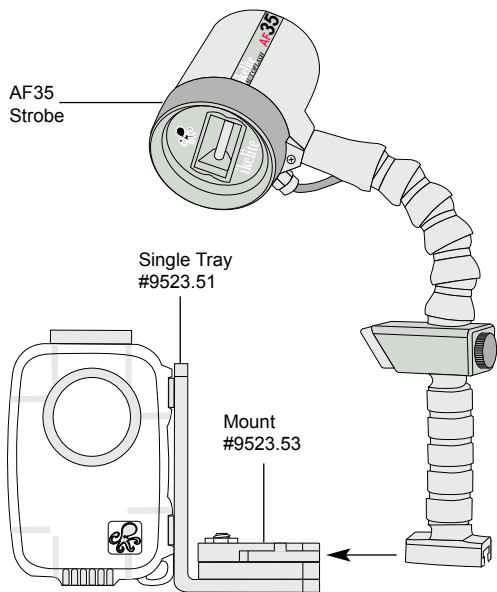

9

## Diffuser and Deflector Installation (continued)

A diffuser and deflector are included with the housing. The diffuser is white transparent plastic. The deflector is also white but is not transparent.

To install the diffuser or deflector, push the "Cut-out" Section into the port groove until it stops.

Note the Small Hole. To avoid losing the diffuser or deflector, you can attach a fishing line or string to this hole.

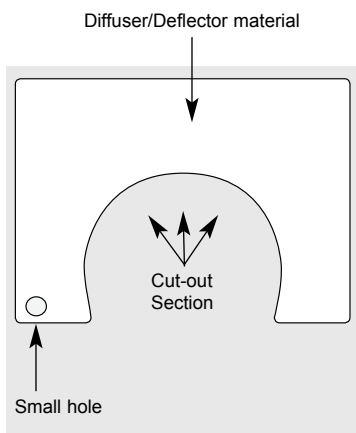

### Diffuser Use

The diffuser should be installed when using the camera flash. When shooting close-up photographs with the camera flash and at the camera lens's widest angle setting, the lens port on the housing can block a portion of the light from the camera flash. This can result in a shadow in a lower corner of the frame. Zoom the lens to eliminate the shadow (*You can test this above water*).

### Deflector Use

The deflector should be installed when using an Ikelite external strobe. The deflector will block and redirect the camera's flash to the AF35 slave unit which controls the external strobe's output.

11

## Optional Accessories (continued)

### Pro-V8 LED Video Lite #6320

Lite kit #6320 includes Pro-V8 lite head, alkaline batteries, flex arm and video housing handle mount. The Pro-V8 features a warm, even 45° beam over a whopping 10-hour burn time. The flex arm allows the light to be repositioned effortlessly. Requires the #9523.51 Video Compact Tray, sold separately. For more light, add a second Pro-V8 LED or the PRO-2800 LED system with the #9523.52 Dual Tray. Requires #9523.51 Tray to attach to the Compact Video Housing.

### PRO-2800 LED Video Lite

The PRO-2800 LED is designed to be used as primary video lighting for any underwater video, digital still or digital SLR system. A perfectly diffused 100 degree beam provides even coverage from macro to wide angle. Near daylight color temperature ensures the most true, natural tones especially when combined with ambient light in seascapes.

### #6328.01 Complete Package with SA-100 Arm

### #6328.02 Complete Package with Flex Arm

Complete information regarding optional accessories available at [http://www.ikelite.com/web\\_two/5620.02.html](http://www.ikelite.com/web_two/5620.02.html)

## Using the Camera's Built-in Flash

For the best results, we recommend using an external Ikelite Substrobe. If you do not have an external flash, the camera's built-in flash can be used with a diffuser installed. This use is limited due to the housing port blocking a portion of the built-in camera flash. Install the Diffuser and zoom in slightly to eliminate any dark areas noted in your photographs. See Diffuser/Deflector Installation below.

**NOTE:** The camera's built-in flash CANNOT be used with optional Wide-Angle or Accessory lenses.

10

## Photo Tips

1. The number one rule in underwater video and photography is to eliminate as much water between the camera and subject as possible. Get as close as you can to the subject, then use the zoom. If you are using flash for still photos, subjects beyond 6 feet (1.8m) will not have much color.
2. The camera's built-in flash is very close to the camera lens. The flash can light up any suspended particles in the water and they can be recorded in your picture. This effect is called backscatter. To eliminate as much backscatter as possible, photograph close. Photograph in clear water; do not stir up the sand or silty bottom. If backscatter becomes a problem in the environment you are photographing, an external flash will help eliminate much of the backscatter.
3. Many digital cameras have a slight lag time between when you press the shutter release button and the camera actually takes the picture. Hold the camera steady a second or two after pressing the shutter release button.
4. Do not shoot down on subjects as they will quite often blend into the background and be difficult to see in the photograph. Shoot subjects straight on or shoot up at a slight angle using the blue water as a contrasting background.
5. Underwater flash is used to restore the warmer colors filtered out by the water as well as to illuminate the subject. When photographing underwater, set the camera to use flash on every shot. If the camera's flash is set to AUTO and the sun is behind your subject, the camera may see enough light and not fire the flash. With the sun behind the subject, the subject is shaded (dark) and needs flash for a good exposure.
6. When using daylight or flash, if your camera consistently over or underexposes the image, you may want to adjust your camera's exposure compensation settings.

12

## Photo Tips (continued)

7. Many photographers transfer their images to the computer where they can fine tune the appearance of the image. Many of the image manipulation programs make you think you can magically correct any image taken and make a good picture. Remember when using an image manipulation program such as Photoshop, that if the image is overexposed, much of the color is missing. If the color is missing you cannot adjust it. If images are slightly underexposed, the color is there, but it is just dark and you can adjust it to some degree. So, if you error in exposure, it is better to have the image slightly underexposed rather than over exposed.

## General Tips

1. Before placing your camera in the housing, it is a good idea to immerse the closed housing in a bucket or rinse tank to make sure it is watertight.
2. Due to the power required to operate the camera and LCD screen, it is a good idea to start each dive with a fully charged camera battery.
3. As soon as you enter the water, take a moment and check the housing to see that it is properly sealed.
4. Next, check to see if there are any bubbles on the face of the lens port. If there are, take your finger and remove them. If there are bubbles on the lens port they can produce soft focus spots in your video.

**NOTE:** Fogging of the port glass may occur due to a variety of environmental factors. To prevent fogging issues, always assemble the housing in a cool, dry area, such as an air conditioned room, and keep the housing out of direct sunlight. If fogging persists, insert a fresh desiccant packet inside the housing before each day of diving. Desiccant packages are not available from Ikelite, however most camera stores carry them.

13

## Ikelite Limited Warranty

All Ikelite products are warranted against any manufacturing defects for a period of one year from the original date of purchase. Defective products should be returned prepaid to Ikelite. Ikelite will, at its discretion, repair or replace such products, and will return to customer prepaid. All other claims of any nature are not covered. Housing is pressure tested and warranted to 200' (60m) maximum underwater depth. Except as mentioned above, no other warranty expressed or implied, applies to this Ikelite product.

## Returning Products for Service

Ikelite is most interested in performing any service to ensure that all products perform as intended. Evidence of purchase date must be provided to obtain warranty service.

No prior authorization is required. You may return directly to us or through your dealer. Please include a brief description of the problem, any relevant e-mail correspondence, and/or instructions on what you want us to do. Always include name, shipping address, e-mail address, and phone number inside of the package.

You may also want to insure the package.

Send Postage Pre-Paid to:

Ikelite Underwater Systems  
ATTN: Repair Dept.  
50 West 33 Street  
Indianapolis, IN 46208 USA

No reimbursements for return freight will be issued.

15

## Housing Maintenance

The Ikelite housing should be given the same care and attention as your other photographic equipment. In addition to normal maintenance we recommend that the housing be returned to Ikelite periodically to be checked and pressure tested.

1. **Do Not** leave the camera and housing in direct sunlight for prolonged periods. Heat may damage the camera.
2. **Do Not** ship the camera in the housing.
3. Keep the back o-ring clean and lightly lubricated. Only apply enough lubricant to make the o-ring feel slick. **Do Not stretch the o-ring.** This light coating of lubricant will help to keep the o-ring from drying out and reduce friction when opening and closing the housing. Keep the area where the o-ring fits and the sealing surface of the housing clean.
4. Rinse the housing exterior thoroughly in freshwater after each saltwater use. Dry with a soft cloth. Dry lens port to eliminate water spotting.

After several uses in saltwater, soak the housing exterior in a mild soap solution, rinse and dry before storage. When storing the housing, remove the back o-ring, lightly lubricate and place in a plastic bag. Place the plastic bag with o-ring inside the housing for safe keeping.

**Push button controls** require no maintenance other than rinsing in freshwater after saltwater use. If a push button control becomes difficult to push, or if it sticks when depressed, soak the housing in luke warm fresh water. After a few minutes operate the push button. If this does not correct the problem, return the housing to Ikelite for routine maintenance.

14

## Returning Products for Service (outside the United States)

For the separate international customs documentation form that you complete to accompany the shipment, please state or designate that the enclosed products were originally manufactured in the USA and are being returned to the manufacturer for repair service. Value of the equipment listed for customs purposes should be zero.

## Ikelite Technical Support

E-mail: [ikelite@ikelite.com](mailto:ikelite@ikelite.com)  
Phone 317.923.4523  
Fax 317.924.7988



**Ikelite Underwater Systems**  
50 West 33rd Street  
Indianapolis, IN 46208 USA