

IKELITE PRO VIDEO-LITE II

#6340.08 100-WATT VERSION

#6340.58 50-WATT VERSION

Add the important dimension of color to your recorded images. Captured images may have a blue-green cast because water absorbs the warmer colors from the ambient light.

Turn on an Ikelite Video-Lite and your subjects will "pop-out" from the background in living color.



Ikelite's Pro Video-Lite features an ultra-compact lite head incorporating a 100W or 50W primary light with a 20W modeling light. Unsurpassed ultra-wide 100° primary light coverage, free of hot spots with 3400°K-color temperature.

Designed exclusively for the Ikelite Video Housings, the Pro Video-Lite provides the best buoyancy control with smaller housings weighing less than 8kg (17 lbs). The battery pack snaps quickly and easily underneath the housing for good weight distribution; no tools needed.

The battery pack accepts one or two lite heads. Since close-up subjects may need less light than distant subjects, add a second lite head with appropriate wattage for dual intensity choices.

DO NOT use the Video-Lite ABOVE water. The water helps cool the lite head.

SPECIFICATIONS

Power.....	13.5-volt / 4.5 amp-hour ni-cad
Recharge Time.....	5 hours
Burn Time (one battery pack).....	25 minutes with 100-watt lamp 55 minutes with 50-watt lamp
Coverage Angle.....	100° for primary light
Color Temperature.....	3400° Kelvin
Surface Weight.....	5.2 pounds / 2.4kg
Underwater Weight.....	12 ounces / .34kg
Depth Rating.....	300 feet / 90 meters

NI-CAD BATTERY PACK #1400

The rechargeable battery pack consists of ten D-cell industrial grade ni-cad batteries (4.5AH rating). It powers the 100W primary lamp for 25 minutes or the 50W primary lamp for 55 minutes per charge. Two lite heads can be connected to the battery pack for more intensity or for dual 50W / 100W intensity choices.

Additional battery packs are available to replace an exhausted pack above water in seconds. Two battery packs can also be stacked; see "Optional" section.

*The battery pack is factory sealed. **DO NOT** disassemble.
Recharge the battery pack after each use.
Fully discharging the pack will shorten the battery life.*

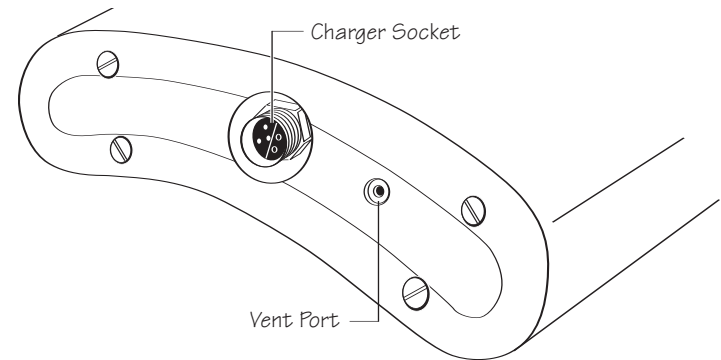

The Pro/SpD Smart Charger is capable of providing a trickle maintenance charge permitting the ni-cad battery pack to be continuously charged for extended periods.

*Recharge the ni-cad pack after each use; **DO NOT** fully discharge. Definitely recharge the ni-cads if the light intensity dims "yellows" because the batteries are nearly depleted and the color temperature is no longer correct. Fully discharging the ni-cads or allowing them to completely lose a charge will shorten the battery life. Store the ni-cad pack fully charged and recharge for a few hours each month.*

CHARGING THE NI-CAD BATTERY PACK

Rotate the in-line switch to the center OFF position and make sure all components are dry. The battery pack features two female connectors, one at each end, to connect one or two lite heads. These connectors on the battery pack also double as charger sockets; either one can be used to recharge the pack.

To access the charger socket, unscrew and remove the cord or waterproof cap. Align the charger plug and insert into the charger socket; note that the plug features only one pin and one receptacle. Make sure the connection is good.

Replace the waterproof cap after charging. The charger sockets are NOT waterproof and must be capped when not connected to the lite head cord.

PRO/SpD SMART CHARGER

The Ikelite Pro/SpD Smart Charger #1403.4 is compatible only with the ni-cad battery pack #1400 featured on the Ikelite SpD and Pro Video-Lite. This charger is NOT compatible with Ikelite Substrobes.

5-HOUR RECHARGE TIME

The Ikelite Pro/SpD Smart Charger is a variable input voltage charger that automatically adjusts for the voltage of the power source, ranging from 100V to 240V. It adapts to current fluctuations in travel destinations with poorly regulated power, provides more complete recharging, and offers trickle maintenance charge. It also prolongs battery life, eliminates any possibility of ni-cad memory, and accepts interchangeable plugs for worldwide use.

CHARGER COMPONENTS

Pro/SpD Smart Charger #1403.4 is packaged with four interchangeable AC adapters for USA, European, United Kingdom, and Australian electric outlets. Choose the appropriate AC adapter for your location and slide the chosen adapter on the back of the charger; it snaps into position. To interchange the adapters, press UP on the adapter to unsnap it from the back of the charger and slide another AC adapter into position.

Note: Charging end only has two connectors. One/Pin, One/Receptacle.

Charger plugs #0171.61, 0171.62, 0171.63 for the original Smart Charger #1403.1, 1403.2, 1403.3 are NOT compatible with the Smart Charger #1403.4.

INDICATOR LIGHTS

The charge indicator light on the Smart Charger shows the present recharge mode. It illuminates once connected to both the electric outlet and the Ikelite battery pack.

CONTINUOUS illuminated light

Indicates that the ni-cad module is being quick-charged.

SLOW BLINKING illuminated light

Indicates that the ni-cad module is fully recharged and the charger is now providing a trickle maintenance charge, which permits the ni-cad module to be continuously charged for extended time periods.

RAPID BLINKING illuminated light

Indicates that the ni-cad module was virtually drained (discharged) and the module is being slow-charged to bring up the ni-cads. Once the ni-cads reach an acceptable level, then the charger will automatically switch to the quick-charge mode.

WARNING:

For the Pro Video-Lite system, the battery pack mounts underneath the Ikelite video system.

The Battery Pack should NEVER be secured directly to the diver because the connecting cable runs to the lite head on the video system. In the event of an emergency, the diver may be unable to free himself from the video system thereby creating an extremely dangerous situation.

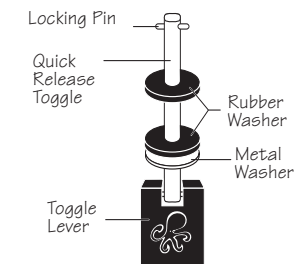
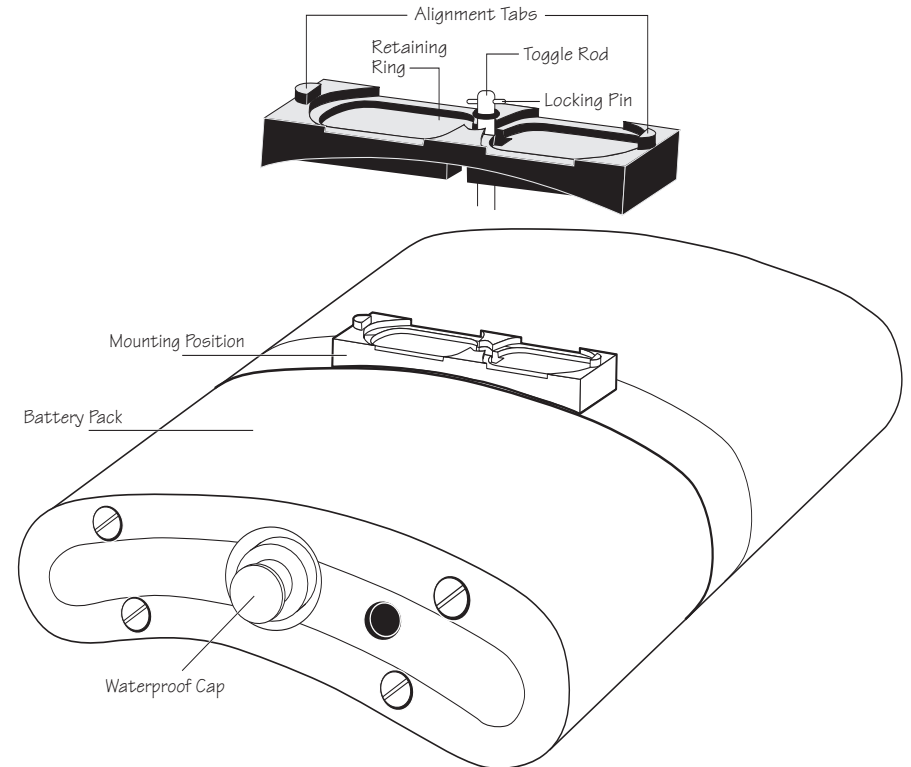

MOUNTING THE BATTERY PACK

The Pro Video-Lite II is designed exclusively for the newer Ikelite Video Cases. It provides the best buoyancy control with smaller housings weighing less than 8kg (17 lbs).

The battery pack snaps quickly and easily underneath the Ikelite housing for good weight distribution; no tools needed. The battery pack attaches to the bottom bar in place of the removable quick-release base.

Most current model Ikelite housings feature the quick-release base molded of **polypropylene** (plastic) and you can simply follow the mounting instructions referenced below. If the Ikelite housing instead features an **aluminum** quick-release base incorporating *lead weight in one or more pockets*, then see the "Adding Weight" section below.

MOUNTING THE BATTERY PACK

Battery pack features a quick release toggle for easy attachment to the bottom bar once the quick-release base has been removed from the housing.

1. Position the Video Case upside down on a flat surface. Detach the quick-release base from the bottom bar on the housing.
2. Pull out on the toggle lever of the battery pack and rotate the lever so the locking pin is horizontal with the mount on the battery pack. If you have the large 17.75cm (7") inside diameter cylindrical housing, you will need to remove the alignment tabs from the battery pack mount.
3. Center the battery pack on the bottom bar and the mount should fit into the bar. Depress the toggle slightly to extend the locking pin thru the bottom bar, rotate the lever 90°, and flip the lever down to lock the battery pack in position.
4. Reverse this procedure to remove the battery pack.

ADDING WEIGHT

Skip this section unless the Ikelite housing features an **aluminum** quick-release base incorporating *lead weight in one or more pockets*.

The battery pack is near neutral buoyancy underwater. Since the **aluminum** quick-release base that you remove from the Video Case incorporates lead weight in one or more pockets, then removing the base and attaching the battery pack will create a positive buoyancy situation underwater.

These larger Video Cases require additional weight to achieve neutral buoyancy with the Pro Video-Lite battery pack. Attach scuba weights to a weight belt and slip the belt thru the stainless support rods underneath the housing. Rest the weights on top of the battery pack and position them in front and behind the bottom bar to achieve balance. Individual weight pouches will facilitate the addition of weight.

LITE HEAD

The Ikelite SA-100 Ball-Socket Arm System mounts the lite head to the Ikelite video housing. The ball-socket system is compact, lightweight and offers flexibility in positioning the lite head.

MOUNTING THE LITE HEAD TO THE ARM

Place the ball mount of the arm into the mounting slot on the bottom of the lite head. Put the mounting bolt through the hole in the ball mount and screw it into the base of the lite head until it is tight. The mounting slot prevents the lite head from rotation.

ATTACHING THE ARM TO THE HOUSING

The tray mount on the arm can be secured to the top or bottom of either housing handle. Remove the black wing nut and washer from the handle. Position the arm's tray mount over the protruding bolt; the counter-sunk side of the tray mount should go against the handle. Replace the washer and wing nut and tighten to secure.

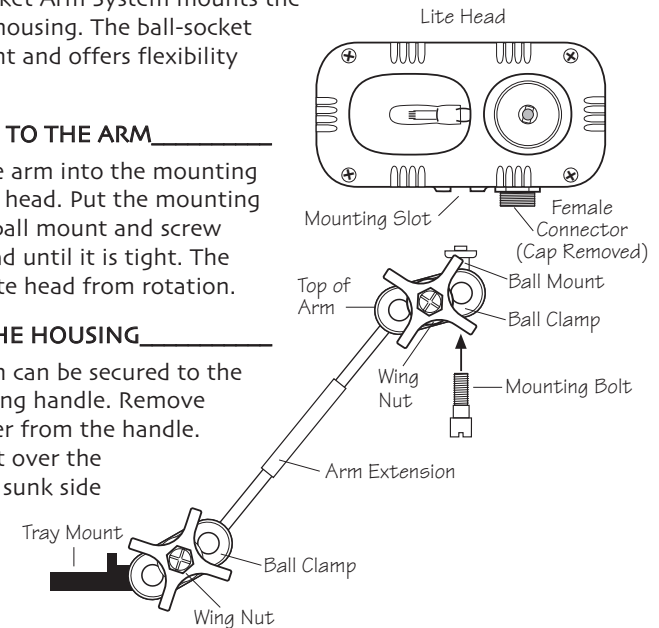

EXPANDABILITY OF THE ARM SYSTEM

Additional arm components are sold separately to allow for expansion or customization of the arm system. Lengthening of the arm allows for mounting to the bottom bar of the handle assembly. See "optional" on pg. 11 for part #'s.

AIMING THE LITE HEAD

Turn the modeling light ON *underwater*. Look thru the camera's viewfinder and aim the lite head so that the modeling light shines in the center of your picture area. If your subject distance greatly changes, you should recheck the aiming of the lite head.

DO NOT use the Video-Lite ABOVE water. The water helps cool the lite head.
Never look into the face of the lite head because of its blinding intensity.

CORD WITH IN-LINE SWITCH

An in-line switch is featured on the cord that connects the battery pack and lite head. The CENTER position on the switch is OFF.

Rotate the switch to the RIGHT to turn ON only the PRIMARY light.

Rotate the switch to the LEFT to turn ON only the MODELING light.

Always rotate the switch to the center OFF position before connecting or disconnecting the cord. We recommend disconnecting the cord during transit to avoid the possibility of the lite head accidentally being switched on.

Before connecting the cord, always turn the switch OFF.

Never look into the face of the lite head because of its blinding intensity.

MOUNTING THE SWITCH

The switch mounts to the top or bottom of the contour handle on the Ikelite housing. Ikelite recommends positioning the switch side DOWN for convenient fingertip operation. To mount the switch, remove the black wing nut and stainless washer from the top of one handle. Position the mount over the protruding bolt. Replace the washer and wing nut and tighten to secure.

When using dual lite heads, switches can be mounted to the bottom of the handle assembly switch side *down*.

CONNECTING THE CORD

The two charger sockets on the battery pack double as connectors for the cord; either connector can be used.

Turn the switch OFF and make sure all components are dry. Remove one waterproof cap from the battery pack to access the connector/charger socket. Keep connector threads on the battery pack AND lite head clean and lightly lubricated. Otherwise, the cord will freeze on the connector. Check the cord o-ring for nicks or cuts; this o-ring must also be kept clean and lightly lubricated. *Never use spray lubricant.*

Both ends of the cord are identical. Either end can be connected to the lite head. Note the positioning of the receptacles and pins. Properly align the cord and insert one end into the lite head and the other end into the battery pack. Hand-tighten the knurled retaining rings on the cord. Then push the connector body further inside and continue to tighten the knurled ring to secure the cord.

DO NOT leave the cord connected for prolonged periods as electrolysis can make removal impossible.

DO NOT disconnect the cord underwater or when wet. Connections are NOT waterproof and must be capped when not connected underwater.

OPENING THE LITE HEAD

Before opening the lite head, always turn the Video-Lite OFF, and allow the bulbs to COOL sufficiently.

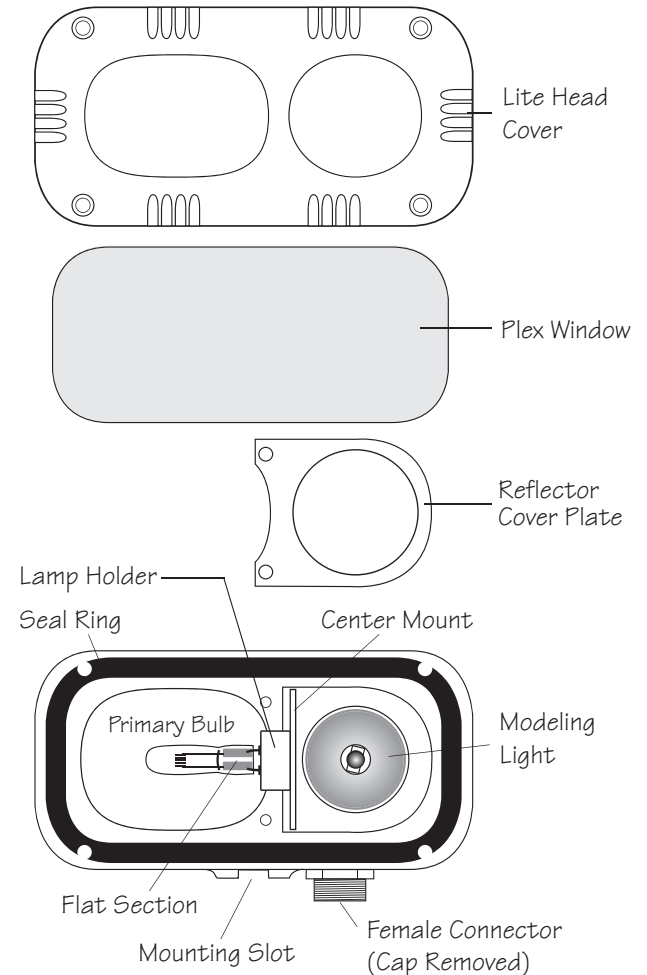

OPENING THE LITE HEAD

It is only necessary to open the lite head when a lamp needs to be replaced.

Turn the switch OFF and disconnect the cord from the lite head. Allow the lamps to cool sufficiently; they reach extreme temperatures during operation and prematurely opening the lite head could subject yourself to burns.

Loosen the four screws. Carefully remove the front of the lite head; the clear lens is NOT permanently secured to the front. Note the positioning of the seal ring on the lite head. Keep the seal ring and sealing surfaces clean. No lubrication is needed.

DO NOT touch the lamps with your fingers. Oil and dirt from your fingers will cause heat concentrations thereby shortening the life..

REPLACING PRIMARY LAMP

Primary lamp 100-watt #0049.51 or 50-watt bulb #0049.50.

1. Make sure the lamps are cool.
2. Remove the two screws that secure the cover plate over the modeling light. Gently lift out lamp holder.
3. Using a soft cloth or tissue, grasp the flat section of the primary lamp. Pull the primary lamp straight out from the holder.
4. For the replacement lamp, again use a soft cloth or tissue to protect the lamp. Align the two pins and insert the lamp into the holder. There will be a small gap between the base of the lamp and the holder.

REPLACING MODELING LIGHT

Modeling light 20-watt #0049.42 lamp/reflector combination.

1. Make sure the lamps are cool.
2. Remove the two screws that secure the cover plate over the modeling light. Gently lift out lamp holder.
3. Grasp the back of the modeling light reflector and pull the reflector straight out from the holder.
4. Use a soft cloth or tissue to protect the inside of the replacement lamp/reflector. Align the two pins and insert the reflector into the holder.

SEALING THE LITE HEAD

1. Place the lamp holder back in the lite head. DO NOT touch the lamps or reflector. Position the metal plate over the modeling light.
2. Make sure the seal ring and sealing surface are clean. No lubrication is needed. Center the seal ring on the lite head.
3. Check that the clear lens is positioned inside the front; place the front on the lite head with the larger oval opening over the primary lamp.
4. Thread the four screws into the lite head. Firmly tighten diagonal screws in succession; make sure all four screws are tight.

MAINTENANCE

We recommend adding an ALL RISK floater to your homeowner's insurance policy in the event you damage, flood, or lose your Ikelite video system. Ikelite warranty does NOT cover customer neglect.

1. Always rinse the Pro Video-Lite in fresh water after each use. It can be cleaned by soaking it in a mild soapy solution. Use a liquid soap; RINSE and DRY the light before storage.
2. Keep the o-ring and sealing surfaces clean. **DO NOT** stretch the o-rings when cleaning. NEVER LUBRICATE THE SEAL RING on the lite head as this may impair the seal underwater. Never use spray lubricant.
3. Keep connector threads on the battery pack AND lite head clean and lightly lubricated. Also keep the cord and waterproof cap o-rings and threads clean and lightly lubricated.
4. Disconnect switch from pack and lite head when in storage.
5. Battery pack is factory sealed; **DO NOT** disassemble. It should be fully recharged monthly. The Smart Charger is capable of providing a trickle maintenance charge permitting the ni-cad battery pack to be continuously charged for extended periods.
6. Recharge the battery pack if the light intensity dims "yellows" because the batteries are nearly depleted and the color temperature is no longer correct. *Fully discharging the batteries may shorten the battery life.*
7. VISUAL INSPECTIONS are important to the maintenance of this system. A forgotten o-ring can cause a lot of damage.

LUBRICANT

Silicone lubricant is provided. Use only enough lubricant to make the item feel slick. Lubricant only reduces friction; it is NOT a sealant. We do NOT recommend lubricating the lite head seal ring.

DO NOT use spray lubricant as it will cause cracking of the plastic.

CAUTION

DO NOT use batteries that have been wet; batteries from a flooded lite should be discarded. The water could create an internal short circuit at some later date causing a potential explosion. The normal evolution of all batteries is emitting hydrogen gas. This gas must be absorbed or allowed to escape to prevent ignition of the entrapped hydrogen/air mixture. A hydrogen absorber has been installed inside this battery pack. Two vent ports are featured on the battery pack to allow a hydrogen/air mixture to escape. **DO NOT** disassemble the battery pack. In case the battery pack floods, return it to Ikelite for repair.

OPTIONAL

PRO LITE HEAD

Add a second lite head for more intensity or for dual 50W / 100W intensity choices since close-up subjects may need less light than distant subjects. Choose from 100-watt #6386.1 or 50-watt #6386.51 Lite Heads. Includes connecting cable with in-line switch and mounting arm.

PRO BATTERY PACK #1400

Additional battery packs are available to replace an exhausted pack above water in seconds. Two battery packs can also be stacked and each connected to a separate lite head; special stacking toggle rod #9362 required. If you prefer to use only one lite head and stack two battery packs for twice the run time, a short connecting cord is also required.

REPLACEMENT LAMPS

100-watt #0049.51 and 50-watt #0049.50 lamps are available for primary lighting. Modeling lamp is 20-watt #0049.42.

ARM SYSTEM

One unique feature of the Ball-Socket Arm System is its adaptability. Additional Arm components are available for purchase to create a "custom" Arm System.

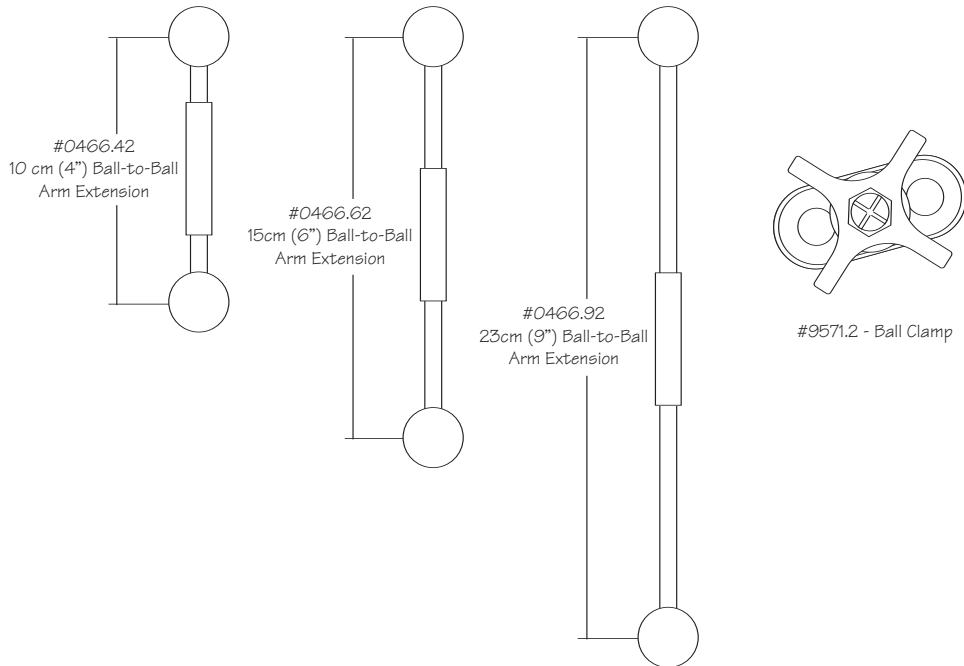

LIMITED WARRANTY

All Ikelite products are warranted against any manufacturing defects for a period of one (1) year from the date of purchase. Defective products should be returned prepaid to Ikelite. Ikelite will, at its discretion, repair or replace such products, and will return to customer prepaid. All other claims, of any nature, including but not limited to bulb failure are not covered. Except as mentioned above, no other warranty expressed or implied, applies to this Ikelite product.

IKELITE UNDERWATER SYSTEMS

50 West 33 Street
PO Box 88100
Indianapolis, IN 46208 USA

317.923.4523

www.ikelite.com
Email ikelite@ikelite.com