



Zoom Clamp and Sleeve Installation Guide



NOTE: This guide will give you the basic information necessary to easily install and remove the black lens zoom clamp and clear sleeve from your lens.

www.ikelite.com

1) First, determine lens type (**Type 1** or **2**).

- **Type 1** lenses have a lens opening that is NOT larger in diameter than the zoom ring (Figure 1).
- **Type 2** lenses have a larger lens opening diameter than the zoom ring (Figure 2). See **Type 2** lens instructions on reverse.

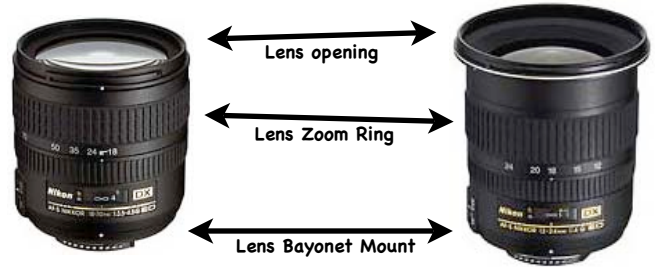

Figure 1 - Type 1 lens

Figure 2 - Type 2 lens

Type 1 installation:

- Maximum lens diameter is limited to 8.4cm (3.3"). The standard diameter for attachment of zoom or focus clamps is limited to 7.1cm (2.8") (Figure F).
- A #5509.28 zoom clamp/sleeve set is included with your housing (Figure G), which allows for larger zoom ring diameters between 71.12mm-76.21mm (2.8"-3.0"). Choose the correct zoom clamp and sleeve (Figure F or G), for your lens.
- For further lens information, consult the housing instruction manual web chart, or website port chart at http://www.ikelite.com/web_pages/slrport.html.
- Install your camera body with the lens attached, into your Ikelite DLSR housing.
- Slip clamp over lens opening (FIGURE A) and place around the lens zoom ring.
- Slide the sleeve over the clamp, aligning sleeve ribs with the clamp grooves (FIGURES B & C). If necessary, expand the clamp diameter (using supplied rubber strips), to better mate clamp grooves with the sleeve ribs.
- Make sure gear sleeve teeth mesh properly with the black housing sleeve drive gear (Figure D).
- Install port with lubed o-ring (FIGURE E). Check zoom operation.

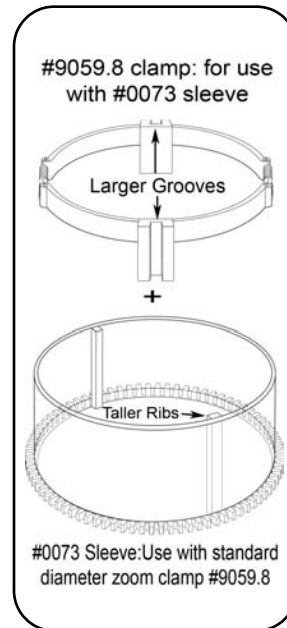

Figure F

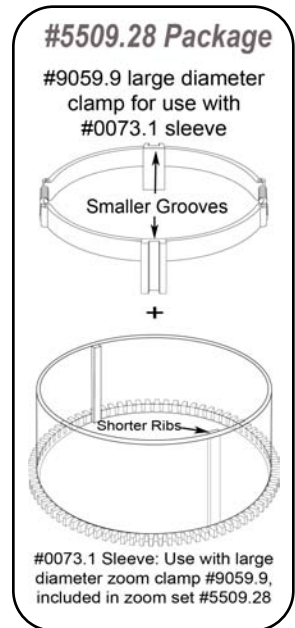
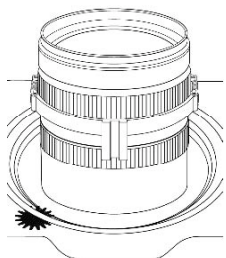
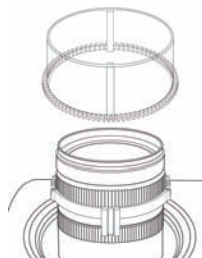

Figure G



TOP OF CAMERA

Figure A



TOP OF CAMERA

Figure B

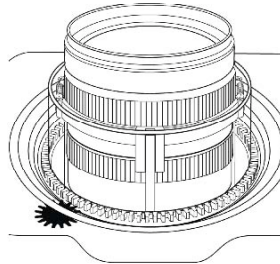

TOP OF CAMERA

Figure C



Figure D

Black Housing Drive Gear



Figure E



Installation Guide - continued



www.ikelite.com

Type 2 installation:

- Maximum lens diameter is limited to 8.4cm (3.3"). The standard zoom ring diameter for attachment of zoom or focus clamps is limited to 7.1cm (2.8") (see Figure F).
- A #5509.28 zoom clamp/sleeve set is included with your housing (Figure G on reverse), allows for larger zoom ring diameters between 71.12mm-76.21mm (2.8"-3.0"). Choose the correct zoom clamp and sleeve (Figure F or G), for your lens.
- For further lens information, consult the housing instruction manual web chart, or website port chart at http://www.ikelite.com/web_pages/slrport.html.
- Install your camera body **without** the lens attached, into your Ikelite DLSR housing.
- Slip clamp over the lens bayonet mount and place around the lens zoom ring (Figure I).
- Orient clamps grooves toward bayonet mount. Make sure grooved tabs don't interfere with lens operation when rotating lens zoom ring. If interference occurs, reverse direction of the clamp grooves.
- Slide the sleeve over the clamp, aligning sleeve ribs with the clamp grooves. If necessary, expand the clamp diameter (using supplied rubber strips), to better mate clamp grooves with the sleeve ribs.
- Make sure gear sleeve teeth mesh properly with the black housing drive gear (Figure D).
- Install port with lubed o-ring (Figure E). Check zoom operation.
- Procedure must be reversed **BEFORE** camera can be removed from your Ikelite housing. Turn lens release control (Figure H) to remove lens/clamp/sleeve combination, then remove the camera body from the housing.

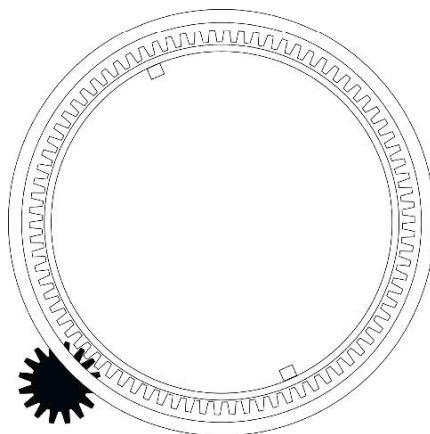

Figure D



Figure H

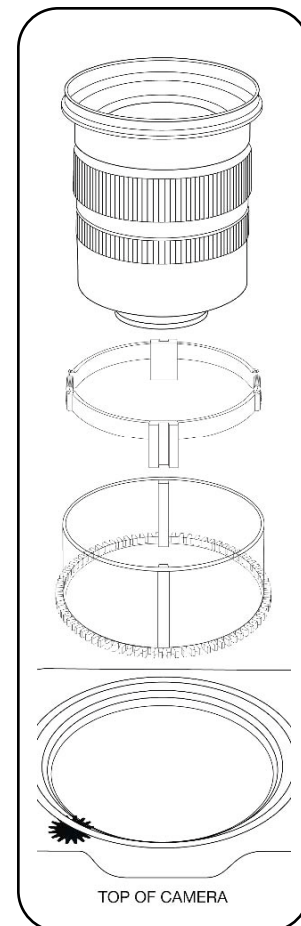

Figure I