

# Flat Modular Port

## instruction manual

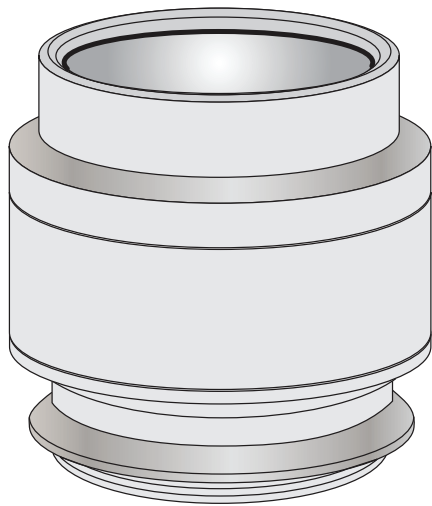

Thank you for your purchase of the Ikelite Flat Modular Port System. Ikelite products have been designed and built in the USA for over 45 years by Ikelite for both the professional and amateur photographer.

Our modular port system allows you to build a port out of universal components to accommodate a variety of macro, zoom, and wide-angle lenses. The interchangeable port bodies and extensions combine to create endless combinations for maximum versatility and performance.

This product should receive the same care and attention as your other photographic products.

Cover the faceplate with the protective cover when not in use.

## Important Information

### Port Seal Inside View

Due to the overhang of the port flange, the port seal is most visible when viewed by looking inside the housing before the camera is inserted. After the port is installed, check to see that the o-ring is properly sealed as shown in Figure 1 and not extruded as shown in Figure 2.

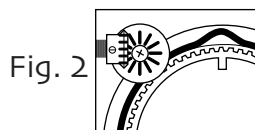
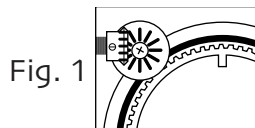

**CAUTION:** When the port will not be used for prolonged periods we recommend unscrewing all sections of the Port. If sections are not unscrewed for prolonged periods it can make unscrewing difficult.

For prolonged storage, the port should be removed from the housing and the port sections should be unscrewed. All o-rings on port sections should be removed, cleaned, lightly lubricated and reinstalled on each port section. If you screw the port sections back together for storage, only engage a few threads leaving the sealing o-ring visible.

Cover the Flat Glass Assembly with protective cover when not in use.

**CAUTION:** Never use spray lubricants as the propellant ingredient can cause cracking in this product.

## Important Notice

Port Bodies are engraved with a Maximum Depth Rating, "RATED 200 FT (60m)". They are engraved on the flat flange that rests against the front of the camera housing; see illustration.

Older Standard and Extended Port Bodies that are NOT ENGRAVED, HAVE A MAXIMUM DEPTH RATING OF 150 FEET (45M). The unmarked Standard or Extended Port Bodies can be returned to Ikelite for a no charge replacement with the newer 200 ft. (60m) rated Bodies, **Send Port Body Only.**

Maximum Depth Rating engraved on flange

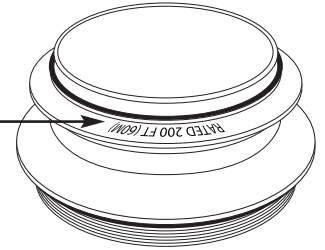

#5510.10 and #5510.11 Superwide Port Bodies are "Rated 200 ft. (60m)" whether or not they are engraved. DO NOT return Superwide bodies for exchange. Superwide bodies are NOT recommended for use with the Modular Flat Port system.

## Special Requirement for Nikon 105mm VR Lens

Use of the new Modular Flat Port with the Nikon 105 VR Macro lens requires modification to early Port Bodies. This modification expands the inner diameter of the Port Body to accept the larger base of the Nikon 105mm VR lens. Port Bodies produced after 4/15/08 will include this modification and will bear the designation "RATED 200FT (60m) LARGE DIA." on the flange that rests against the housing body. Early Port Bodies without this designation may be returned directly to Ikelite to be modified for use with the Nikon 105mm VR Lens.

## Screwing Modules Together

Once prepared for assembly the modules can be screwed together and only need to be hand tight. A strap wrench is supplied and can be used to assemble or disassemble as required.

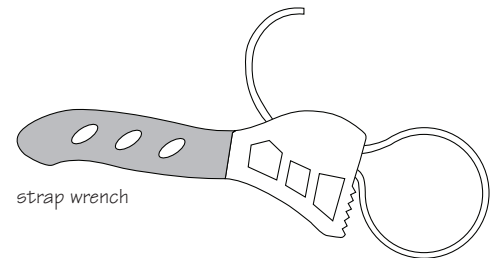

## Preparing the Flat Assembly Module for Installation

The Flat Assembly Module has an o-ring that seals and holds the clear faceplate in place. **Do Not** remove the clear faceplate o-ring. The interior and exterior of the clear faceplate can be cleaned with fresh water or water with a mild non-abrasive soap. On the inside of the Flat Assembly Module just below the internal threads is a flat sealing surface. This sealing surface is where the o-ring on the Port Body or Extension Ring will seal when they are screwed together. Make sure the threads and sealing surface are clean. Use a Q-tip and fresh water, or water with a mild non-abrasive soap to clean.

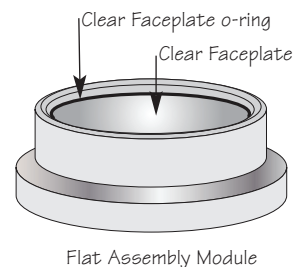

## Preparing Port Bodies and O-rings for Installation

The Port Body has 2 o-rings. The o-ring on the bottom seals against the port opening in the SLR-DC housing. The top o-ring seals against an Extension Ring or the Flat Port Assembly. Both o-rings should be clean and lightly lubricated before installation. To remove the top o-ring from its groove, use a non-sharp instrument such as a small flat bladed screwdriver. O-rings can be cleaned with fresh water. To lubricate the o-ring, put a small amount of lubricant on your finger tips and gently pull the o-ring through your fingers. Use only a small amount of lubricant. The o-ring only needs a light coating of lubricant, just enough to make it feel slick. Remove any excess lubricant as it can collect foreign particles such as sand, which can interfere with sealing. When gently pulling the o-ring through your fingers, do not stretch the o-ring. Check the o-ring groove where the o-ring fits on the Port Body to make sure it is clean. Use Q-tips and fresh water, or water with a mild non-abrasive soap to clean the groove. Also check the port opening in the housing where the housing/port o-ring will seal to make sure it is clean.

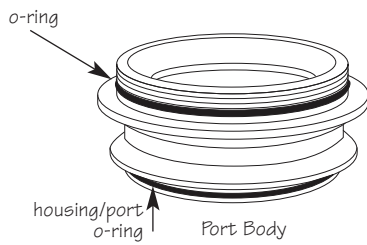

#5510.10 and #5510.11 Super-Wide Port Bodies are NOT recommended for use with the Modular Flat Port system.

5

## Preparing Port Extensions for Installation

### Non-Focus Extension Module

If an extension ring is used in your Flat Port system, the o-ring below the outer threads should be removed, cleaned, and lightly lubricated before installing the Flat Port Assembly.

On the inside of the Extension Ring just below the internal threads is a flat sealing surface. This sealing surface is where the o-ring on the Port Body will seal when they are screwed together. Make sure the threads and sealing surface are clean, use a Q-tip with fresh water, or water with a mild non-abrasive soap solution.

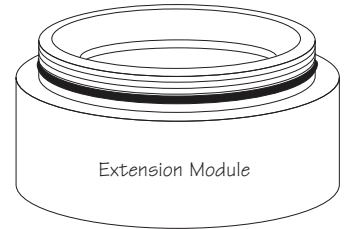

For proper o-ring preparation, Refer to page 5 (**Preparing Port Bodies and O-rings for Installation**) .

### Focus Extension Module #5510.75

If you are using a Focus Extension Module, please refer to your Ikelite Manual Focus Port Extension #5510.75 instruction manual for proper installation.

**Focus Extension Module is not to be used with Super-Wide Port Body #5510.10 or #5510.11**

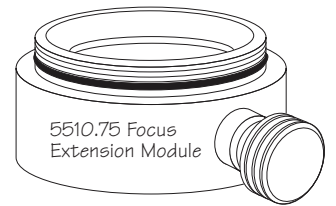

6

## Assembling the Flat Port

Port consists of Flat Assembly Module and Port Body Module

Assemble the Flat Port by screwing each module together as shown. Modules only need to be hand tight.

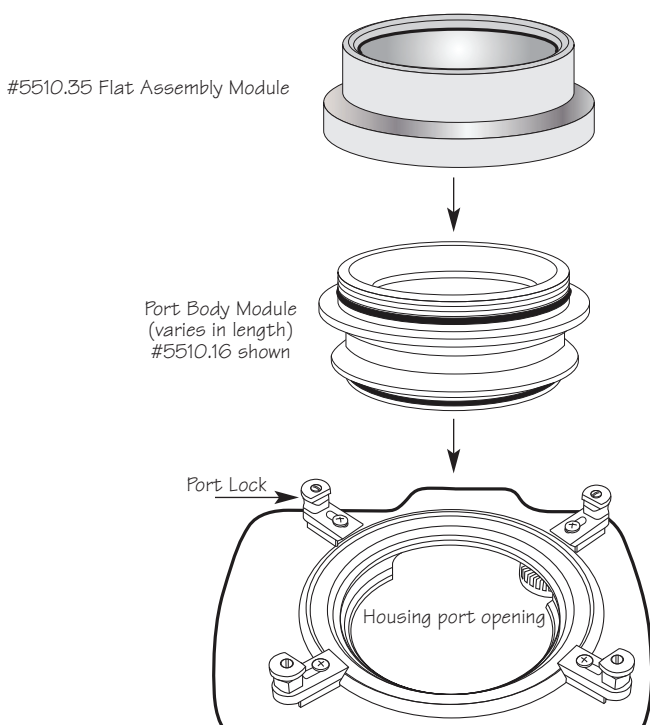

7

## Assembling the Flat Port

Port consists of Flat Assembly Module, Extension Module or Focus Extension Module, and Port Body Module.

Assemble the Modular Flat Port by screwing each module together as shown. Modules only need to be hand tight.

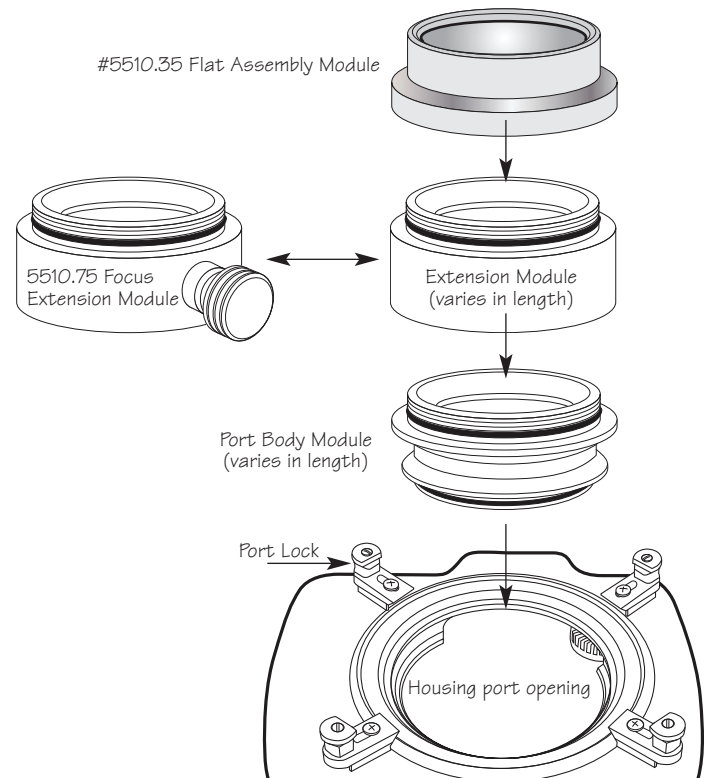

8

## Installing the Modular Flat Port

There are four port locks on the front of the housing. Each Port Lock has a Release Button. Lift the release button and slide each Port Lock away from the port opening before installing the port. In the unlocked position, the Release Button will remain in the up or open position as shown.

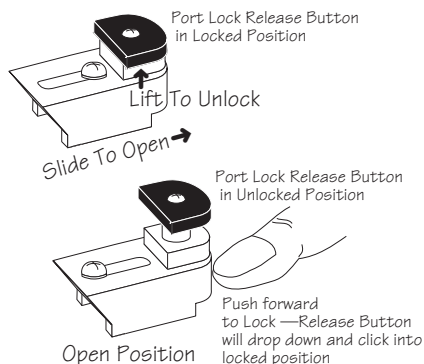

The housing port seal is a piston seal and requires that the housing/port o-ring be lightly lubricated for easy installation. Put a small amount of lubricant on your fingers and gently pull the o-ring through your fingers to lightly lubricate it. Do not stretch the o-ring. Check that the lip of the Port Body where the o-ring fits and the sealing surface on the housing are clean. Place the o-ring back onto the Port Body. Place the port and o-ring into the housing's port opening. Press down on the port firmly and evenly until you feel the port slide into place. Continue to push down on the port. Using your other hand, push each port lock forward. The Release Button on the port lock will drop down and click into the locked position.

**Visually check the port locks** before each dive to make sure they are in the down and locked position. Do not rely solely on the audible click when pushing each port lock in.

**Check around the perimeter of the port seal** to see that the o-ring is properly sealed and not extruded.

9

## Maintenance

After each dive, the exterior of the housing and Port should be rinsed thoroughly in fresh water and dried with a soft cloth. Remove any water spots from the port assembly faceplate as they can cause blurry spots in the photographs.

After prolonged saltwater use, the exterior of the Port and housing should be soaked in a mild non-abrasive liquid soap and water solution. Rinse thoroughly and dry with a soft cloth.

## Ikelite Limited Warranty

All Ikelite products are warranted against any manufacturing defects for a period of one year from the original date of purchase. Defective products should be returned prepaid to Ikelite. Ikelite will, at its discretion, repair or replace such products, and will return to customer prepaid. All other claims of any nature are not covered. Housing is pressure tested and warranted to 200' (60m) maximum underwater depth. Except as mentioned above, no other warranty expressed or implied, applies to this Ikelite product.

10

## Returning Products for Service

Ikelite is most interested in performing any service to assure that all products perform as intended. For repair or service, return the product to the address below with your name, address, phone number and a brief description of the problem. Evidence of purchase date must be provided to obtain warranty service. Normal service turnaround time is approximately 2-3 weeks.



Ikelite Underwater Systems  
50 W 33rd Street  
Indianapolis, IN 46208 USA

When returning products, send "attn. Repair Dept."

317-923-4523

"general questions" e-mail: [ikelite@ikelite.com](mailto:ikelite@ikelite.com)  
[www.ikelite.com](http://www.ikelite.com)